

Vedere A - A

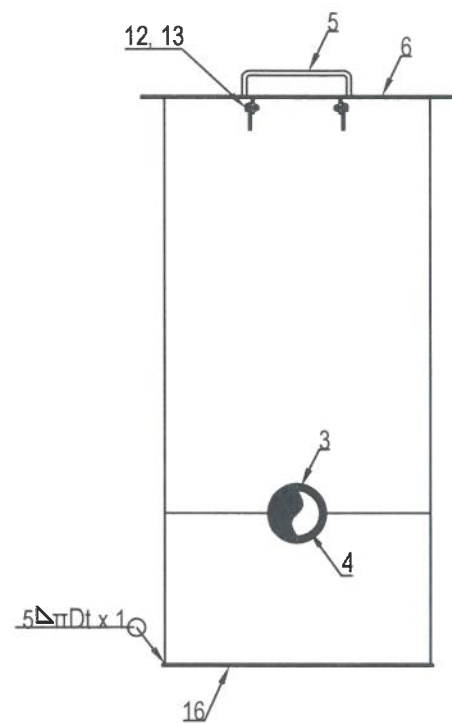

Detaliu izolare ventil si montaj tub protector

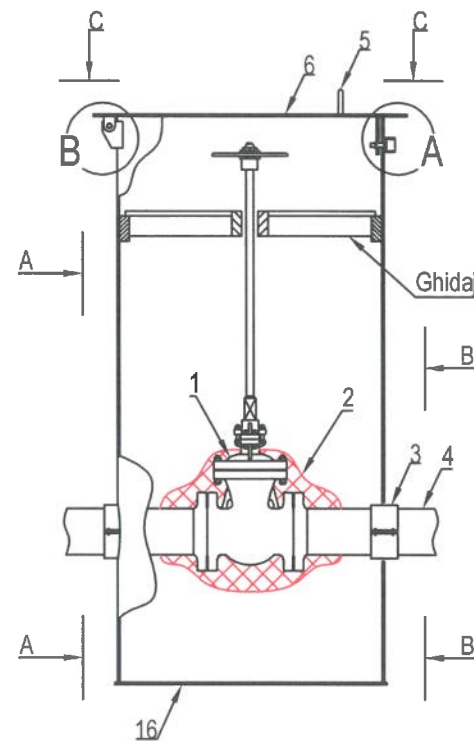

Vedere B - B

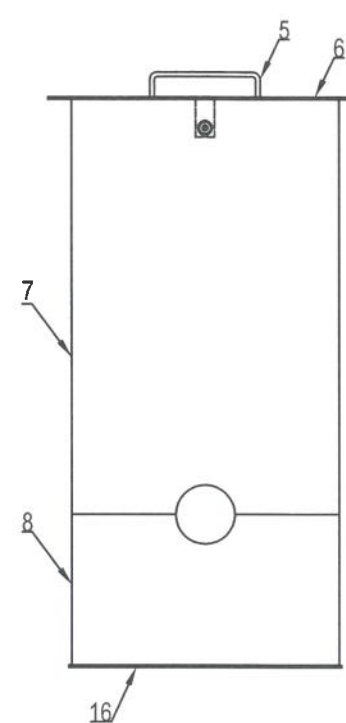

Vedere in plan C - C

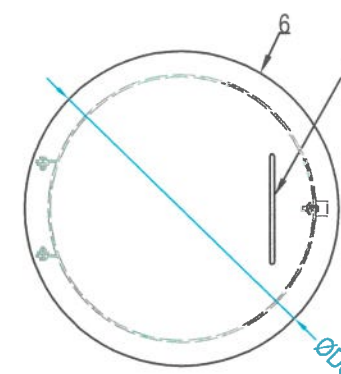

Detaliu "6"

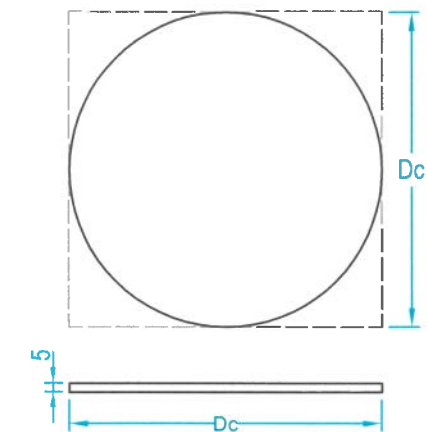

Detaliu tub superior "7"

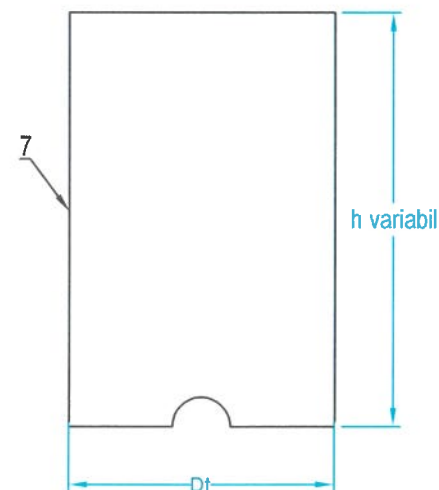

Detaliu tub inferior "8"

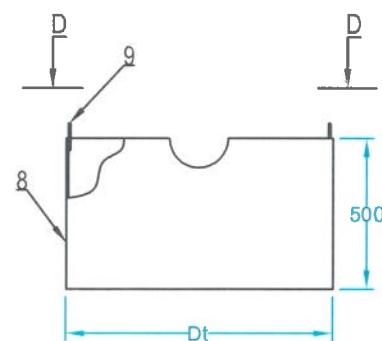

Vedere D - D

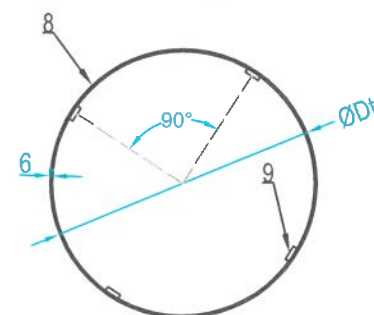

Detaliu "16"

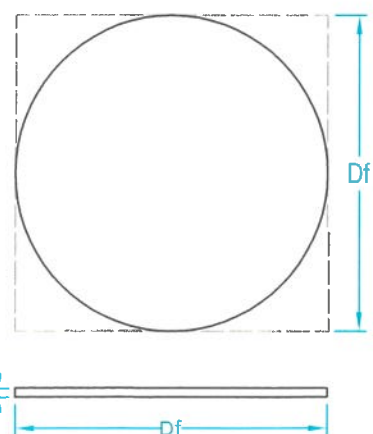

Dimensiuni tub protector				
DN ventil	Dt	Grosime tub [mm]	Dc	Df
600	2235	8.8	2307	2307

Poz.	Denumire	Dimensiuni	STAS	Material	Cantitati
1	Robinet cu sertar pana	DN 600		A216 + 13Cr	
2	Mastic izolator		KEBU PLAST MASTIC		
3	Inel distantier			MDPE	2
4	Teava		SR EN ISO 3183:2020	L 360N	
5	Maner	Ø12 x 400mm	SR EN 10060:2004	OL 37.2K	1
6	Capac	Tb. 5mm	SR EN 10029:2011	OL 37.2K	1
7	Manta camin superioara	ØDt x 7.1	SR EN ISO 3183:2020	L 245N	
8	Manta camin inferioara	ØDt x 7.1 x 500mm	SR EN ISO 3183:2020	L 245N	
9	Platbanda ghidare tub	100 x 40 x 5mm	SR EN 10058:2004	OL 37.2K	4
10	Protector surub	Ø1 1/2" x 3.6 x 30mm	STAS 8185:88	OLT 45	1
11	Tabla groasa	100 x 50 x 6mm	SR EN 10058:2004	OL 37.2K	1
12	Surub	M10 x 50	SR EN ISO 4018:2011		3
13	Piulita	M10	SR EN ISO 4034:2013		3
14	Tabla groasa	70 x 55 x 6mm	SR EN 10058:2004	OL 37.2K	2
15	Tabla groasa	40 x 30 x 6mm	SR EN 10058:2004	OL 37.2K	2
16	Fund camin	Tb. 5mm	SR EN 10029:2011	OL 37.2K	1

GREUTATE CAMIN IN FUNCTIE DE INALTIME

Greutate capac camin [Kg]	289.1	289.1	289.1	289.1	289.1	289.1	289.1	289.1	289.1	289.1
Greutate fund camin [Kg]	289.1	289.1	289.1	289.1	289.1	289.1	289.1	289.1	289.1	289.1
Greutate tub pe ml [Kg]	483	483.0	483.0	483.0	483.0	483.0	483.0	483.0	483.0	483.0
H [m]	1.5	2.0	2.5	3.0	3.5	4.0	4.5	5.0	5.5	6.0
Greutate [Kg]	1313.7	1555.2	1796.7	2038.2	2279.7	2521.2	2762.7	3004.2	3245.7	3487.2

NOTA:

Protectia anticoroziva a caminului se va face prin vopsire conform SR EN ISO 12944:2002

- doua straturi grund epoxidic cu Zn, cu grosime totala strat uscat 75 - 80 µm;
- vopsea epoxidica clorcauciuc in doua straturi.

Verificator/
Expert

Nume

Semnatura

Cerinta

Referat / Expertiza Nr. / Data

Asocierea S.C. SNIF PROIECT S.A.
S.C. ATANASIU & SKILLS S.R.L.

Beneficiar:
CONPET S.A. PLOIESTI

Pr. nr.
414/2022

Specificatie

Nume

Semnatura

Scara:

"Inlocuirea a doua tronsoane din conducta Ø24" Baraganu - Rafinarie Petrobrazii, subtraversare paraul Leaotul (cca. 100 m subtraversare paraul Leaotul si cca. 464 m aflati in proximitatea localitatii Pietrosani, rest din investitia anterioara de 1700 m realizata in anul 2020)"

Faza

PT-CS+DE

Desenat

Ing. Radu Florin

Data:

2024

DETALIU IZOLARE VENTIL SI MONTAJ TUB
PROTECTOR

Pl. nr.

16